



SeaProtect dB-Flex Alu

Quietude Constructions

ISOVER **SeaProtect dB-Flex Alu** is a sound protection membrane which, **combined with U SeaProtect Constructions**, provides turnkey solutions **achieving very high sound reduction performance levels (up to 53-54 dB)**.

This new solution is particularly adapted to increase sound protection in the medium-low frequency range for specific areas on board of a ship such as engine or machinery rooms, discos, theatres, cinemas.

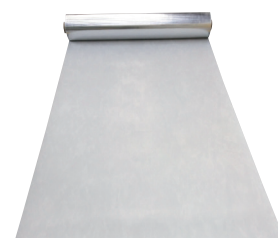

Main benefits

Full Solution combined with SeaProtect Alu Tape



- Very high sound reduction performance
- Easy and quick to install
- Multiple delivery forms
- Strong and mechanically robust
- Low Flame Spread certificate (FTP Code 2010)

Main characteristics



- Reinforced Alu finishing
- Thickness: 1.5mm
- Gramweight: 3 kg/m²
- working temp. -20 to 70 °C
- Steady state temp. -40 to 100 °C
- Storage: 12 months at 20 °C

Delivery form	height [mm]	length [m]	Packing mm on 1 mandrel	total [m ²]
Rolls (max. 20 Kg)	1,200	5	1 x 1,200	6
	1,200	5	2 x 600	6
	800	7.5	2 x 400	6
	600	10	2 x 300	6
Prefaced on ULTIMATE SeaProtect products	Customized dimensions on demand			

ISOVER Marine & Offshore team carried out intensive acoustic measurement campaigns on multiple configurations. Ask to your ISOVER local representative and find the best solution adapted to your needs balancing performance targeted and total installed costs.



Optimal acoustic design with SeaProtect systems



STEEL constructions with SeaProtect dB-Flex Alu

Sound reduction measurements* (dB)

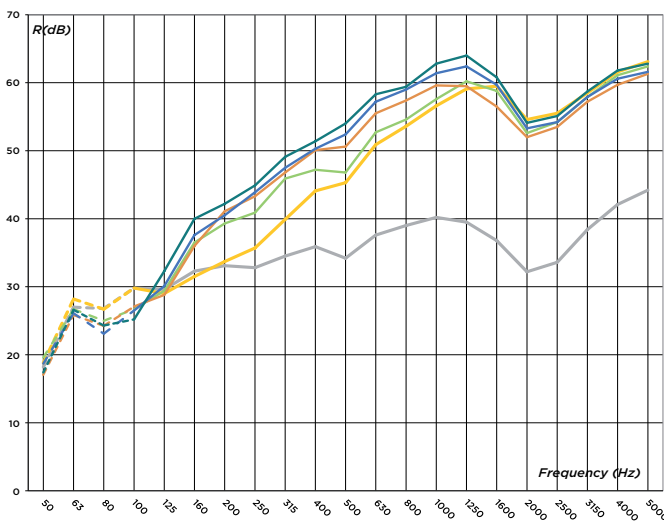

- Reference plate 6 mm
- U SeaProtect [36/70] + 76/25
- U SeaProtect [36/70] + 76/25 + SeaProtect dB-Flex Alu only on the plate
- U SeaProtect [36/70] + SeaProtect db-Flex Alu on the plate & stiffener (Quick-Cover System)
- U SeaProtect [36/70] + 76/25 + SeaProtect dB Flex Alu on the plate & stiffener (Quick-Cover System)
- BCC U SeaProtect [36/70 + 24/50] + 76/25 + SeaProtect dB-Flex Alu on top

* Measurements by SAINT-GOBAIN CRDC Chantereine laboratory, April 2016 according to ISO EN 140-3

Steel constructions without SeaProtect dB-Flex Alu

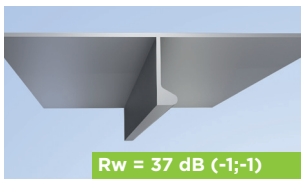

Steel Plate:
6 mm + Stiffeners x 2
L-shape:
115 mm x 80 mm 10 mm thick
Dimensions: 2.18 m x 1.85 m

Rw = 37 dB (-1;-1)

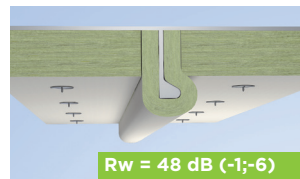

Plate:
U SeaProtect Roll 36 70 mm
Stiffener:
U SeaProtect Slab 76 25 mm

Rw = 48 dB (-1;-6)

Steel constructions with SeaProtect dB-Flex Alu

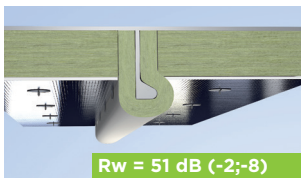

Plate:
U SeaProtect Roll 36 70 mm
+ **SeaProtect dB-Flex Alu**
Stiffener:
U SeaProtect Slab 76 25 mm

Rw = 51 dB (-2;-8)

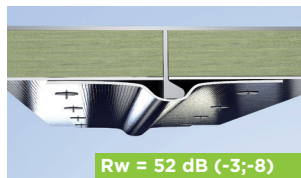

Plate:
U SeaProtect Roll 36 70 mm
+ **SeaProtect dB-Flex Alu**
Stiffener:
SeaProtect dB-Flex Alu

Rw = 52 dB (-3;-8)

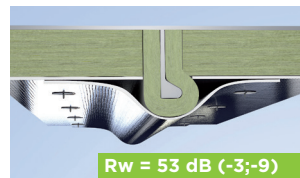

Plate:
U SeaProtect Roll 36 70 mm
+ **SeaProtect dB-Flex Alu**
Stiffener:
U SeaProtect Slab 76 25 mm
+ **SeaProtect dB-Flex Alu**

Rw = 53 dB (-3;-9)

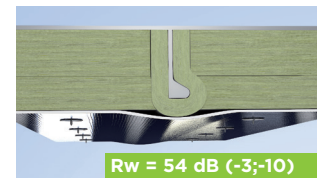

Plate: U SeaProtect Roll 36 70 mm
+ U SeaProtect Roll 24 50 mm
+ **SeaProtect dB-Flex Alu**
Stiffener: U SeaProtect Slab 76 25 mm
+ **SeaProtect dB-Flex Alu**

Rw = 54 dB (-3;-10)